

# 封底的另一面留白，书本形式

## 封底 封面 封面内页

120.00 mm

160.00 mm

GVM  
GREAT VIDEO MAKER



Web: www.gvmltd.com  
8xH Email: bh@gvmltd.com  
GVM Email: support@gvmltd.com  
Amazon Email: amazon-support@gvmltd.com  
Warehouse Add: 4301 N Delaware ave, unit D, PHILADELPHIA, PA19137, USA

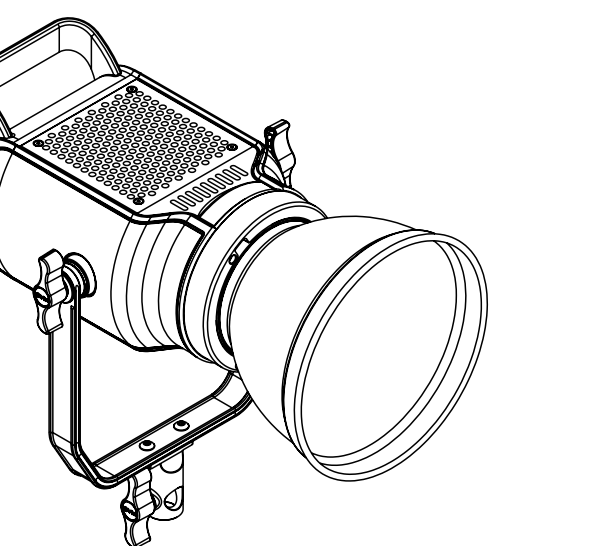

GVM  
GREAT VIDEO MAKER  
GVM-SD200D

## CONTENTS

Product introduction	Page 1
Disclaimers	Page 2
Use and preservation	Page 2
Product parameter	Page 3
Product structure analysis	Page 4
Installation method	Page 5~7
Description of product control keys	Page 8
Function introduction and instruction	Page 9~10
APP control	Page 11
Simple faults and troubleshooting	Page 12
Precautions	Page 12
Packing list	Page 13

## PRODUCT INTRODUCTION

Welcome to "GVM-SD200D", this product is specially designed for senior photography enthusiasts. The product is suitable for live streaming / outdoor / studio photography, and also for YouTube video shooting.

The main features of the product are:

① Stepless adjustable light brightness, dual color temperature 3200K~5600K. It has a high color render index CRI 97+ COB lamp bead. It helps to restore the color of objects and provides you with natural and vivid shooting effects.

② App intelligent control system, which can be controlled by your intelligent mobile device.

③ It has LCD display and a stable system, which supports 360° rotation and can effectively control light. It is also equipped with a standard lampshade. After installation, it can avoid excess light and make the light more concentrated. Custom control fills the light, allowing you to easily and easily shoot the desired results.

We believe that once using our product correctly, you can make huge progress when shooting. Before using the product, you are strongly recommended to read the instructions below carefully.

## DISCLAIMERS

- Before using this product, please read the instructions carefully and make sure to use the product correctly. If you don't obey the instructions and warnings, you maybe cause harm to yourself and the people around or even damage the product and other things around.
- Once you use this product, you are deemed to have read the disclaimer and warning carefully, understand and acknowledge all the terms and contents of this statement, and promise to take full responsibility for the use of this product and possible consequences.
- The design and specifications are subject to change without notice.

## USE AND PRESERVATION

Do not put the light in a highly humid, strong electromagnetic field, direct sunlight, high-temperature environment. If the light is not used for a long time, please disconnect the power.

**Clean:** Before cleaning, please unplug the power plug. And use wet cloth rather than any detergent or soluble liquid, avoiding damaging the surface layer.

**Power:** Make sure the power is in the demanded range, not too high or too low. Correctly load the battery, in order not the damage to the machine.

**Repairing:** If there is fault or performance degradation, do not unpack the shell by yourself, avoiding damage to the machine and lose the right of maintenance. When there is a fault, do not hesitate to contact us, and we will do our best to deal with the problem.

**Accessories:** Please use the accessories provided by the manufacturer and approved ones, in order to maximize the performance.

**Guarantee:** Do does not modify the product, or you will lose the right of maintenance.

## PRODUCT PARAMETER

- Brand : GVM
- Product model : GVM-SD200D
- Product Name : Photography lights
- Product Type : Photography Fill Light
- Lamp beads quantity : COB\*1
- Color rendering index : ≥97
- Color temperature : 3200K~5600K
- Lumen : 35000lux/0.5m ; 10000lux/1m
- Add standard lampshade: 93000lux/0.5m ; 25000lux/1m
- Light adjustment method : Stepless adjustment
- Function / Feature : APP, master/slave mode control, High display, LCD screen

- Product Weight : 3.15KG
- Product Size (mm) : 228x133x349
- Power : 200W
- Voltage : AC 100-240V
- Power supply mode : DC input
- Power supply : DC32V/7A
- Cooling : Radiator & fan cooling
- Product material : Aluminum alloy + plastic
- Commodity origin : Huizhou, China

## PRODUCT STRUCTURE ANALYSIS

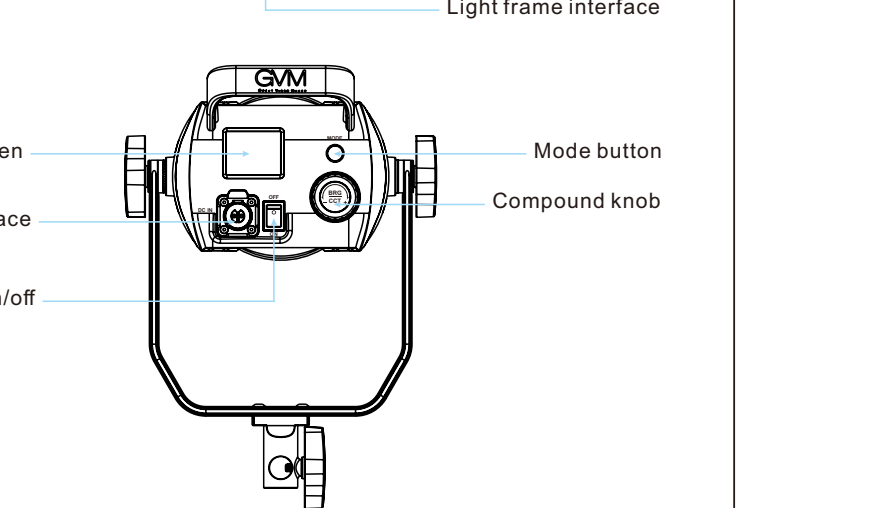
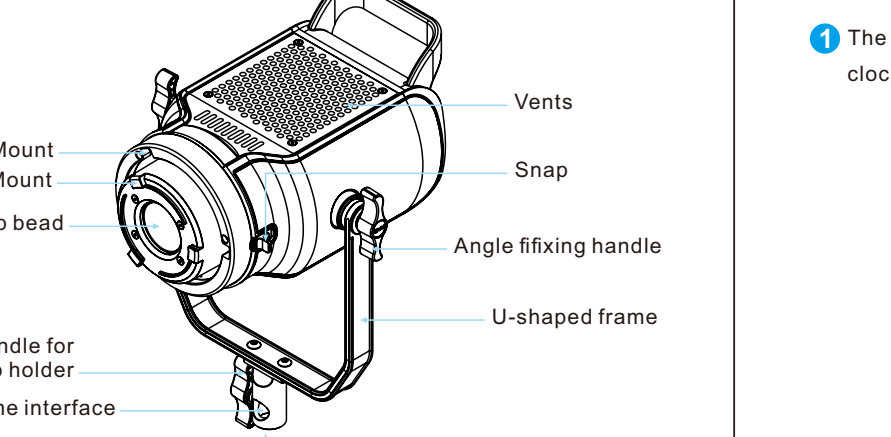

## INSTALLATION METHOD

- The lamp can be installed and fixed on the bracket by rotating the knob clockwise, and unloaded by rotating in the counterclockwise direction.

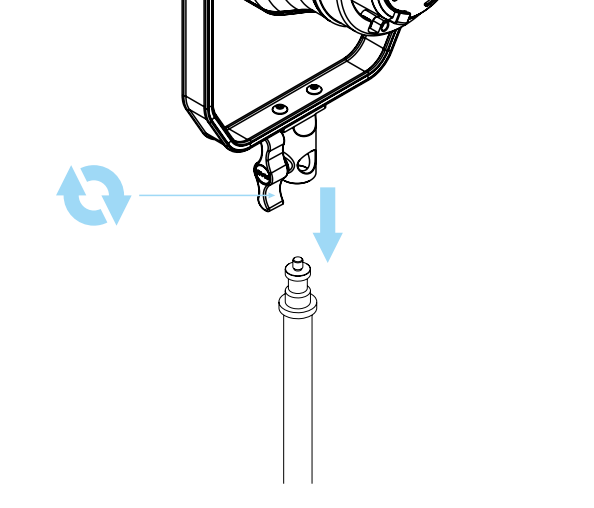
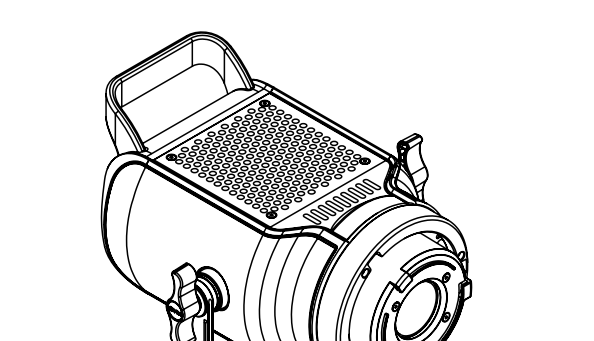

## INSTALLATION METHOD

- Insert the Bowens mount of the standard lampshade into the Bowens mount of the light, and then turn it slightly clockwise.

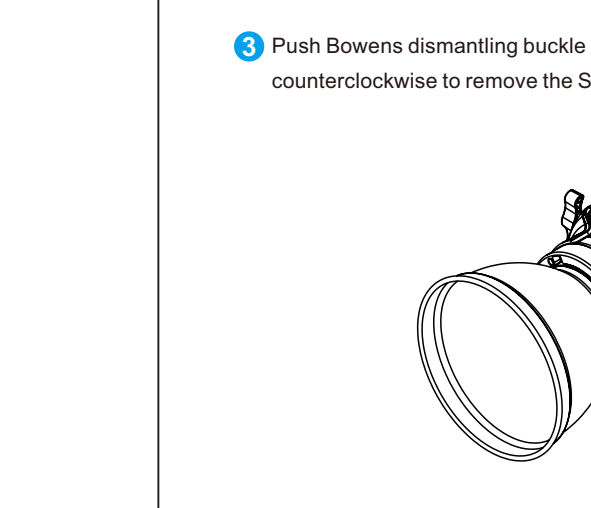
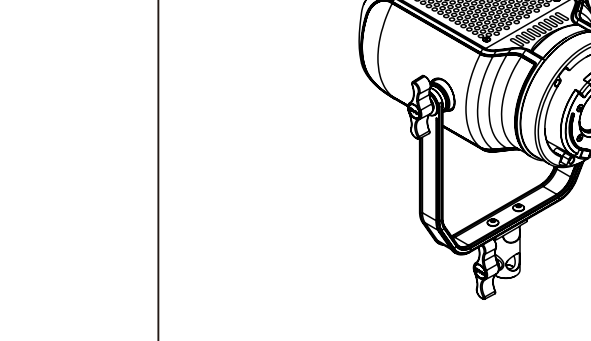

## INSTALLATION METHOD

- Push Bowens dismantling buckle back while rotate the Standard lampshade counterclockwise to remove the Standard lampshade.

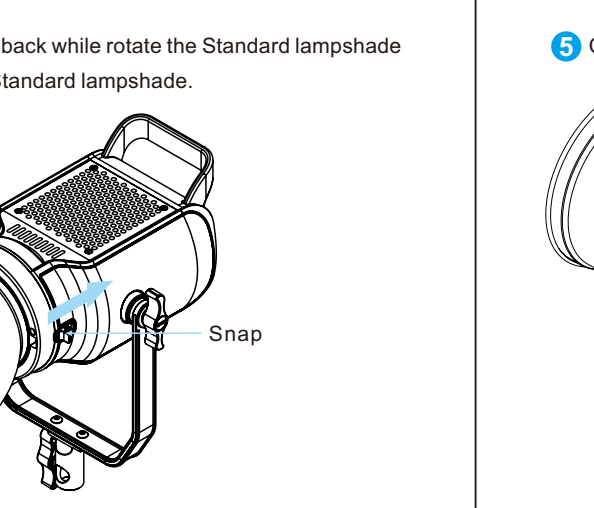
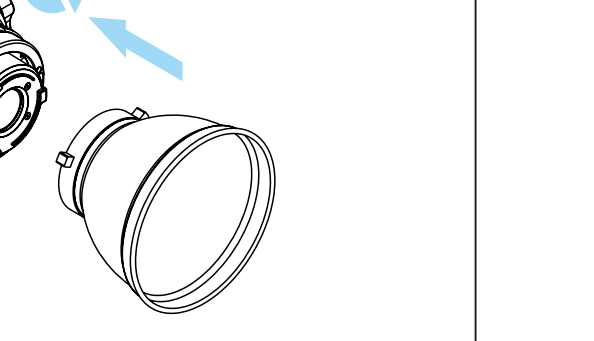

## INSTALLATION METHOD

- Loosen the angle fixing handle, adjust the angle of the spotlight that you need, and then turn the angle fixing handle tightly.

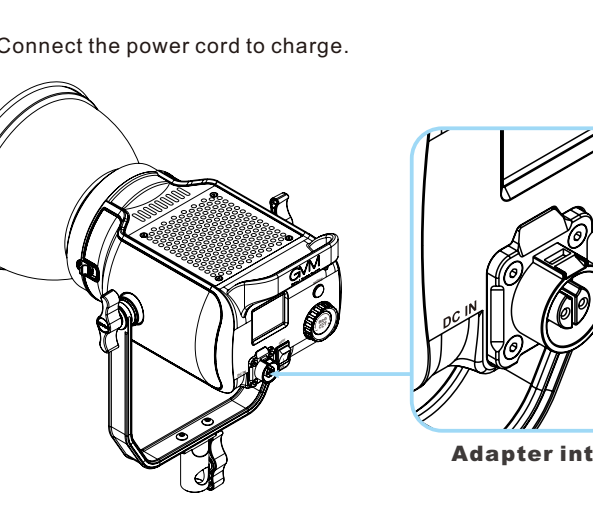
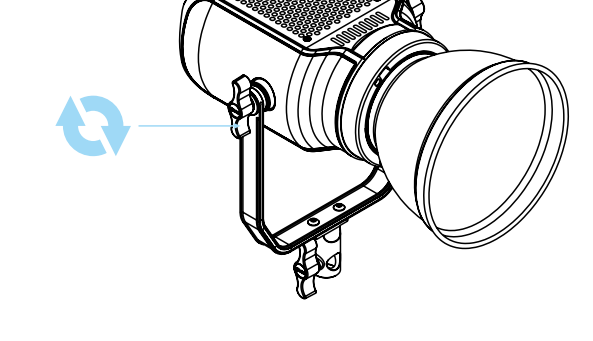

## INSTALLATION METHOD

- Connect the power cord to charge.

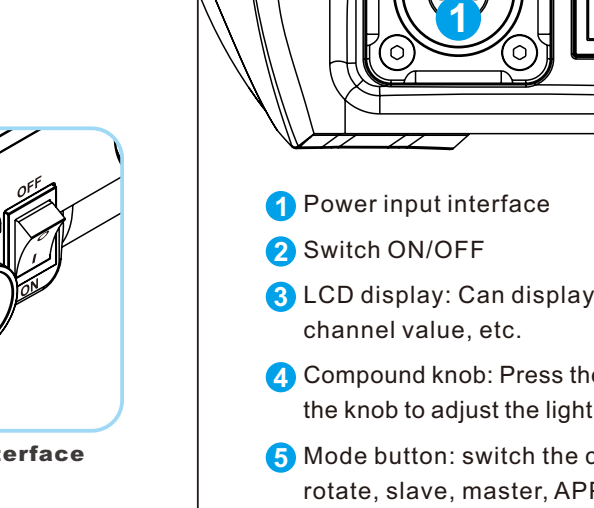
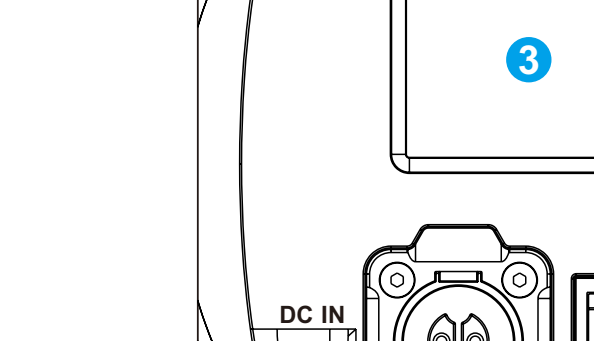

## DESCRIPTION OF PRODUCT CONTROL KEYS

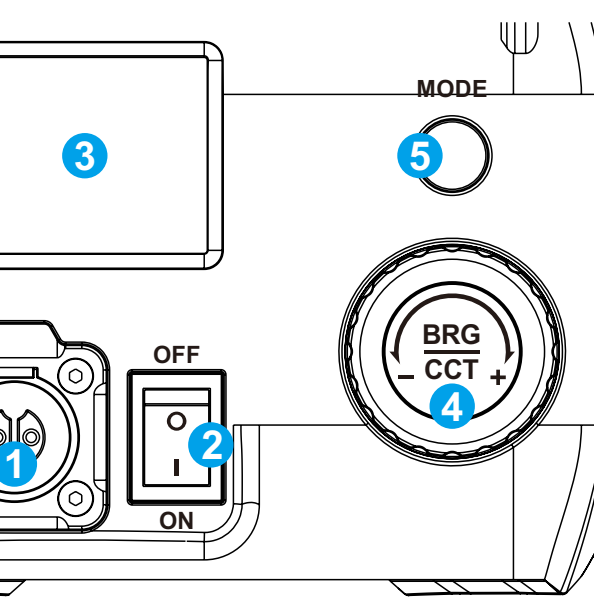

- Power input interface
- Switch ON/OFF
- LCD display: Can display data such as mode, brightness, channel value, etc.
- Compound knob: Press the knob button to switch the mode, rotate the knob to adjust the lighting parameters
- Mode button: switch the control mode. The modes include: rotate, slave, master, APP

## FUNCTION INSTRUCTION & INSTRUCTION FOR USE

- LCD screen:** Data such as mode, brightness, color temperature, channel value can be displayed.

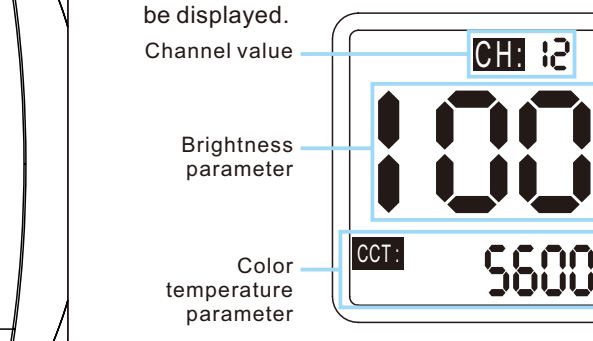

- Mode types and functions:** Press the mode key to switch the control mode, which are: Rotate, Master, Slave, APP. **Rotate mode:** The brightness and color temperature can be adjusted through the compound knob. **Master mode:** The brightness, color temperature and channel can be adjusted through the composite knob and the slaves of the same channel will also be controlled synchronously. **Slave mode:** The channel can only be adjusted by the compound knob. When the channels of the slave and the master are the same, they can be synchronously controlled by the master. **APP mode:** The channel can only be adjusted through the compound knob, and the light can be adjusted through the APP.

## FUNCTION INSTRUCTION & INSTRUCTION FOR USE

- Adjust brightness (BRG):** Range 0%~100%.

- Rotate mode or master mode: Switch to brightness adjustment by pressing the composite knob, and turn the composite knob to adjust the brightness.
- APP mode: Connect to the APP and adjust the brightness through the APP.

- Adjust color temperature (CCT):** Range 3200K~5600K.

- Rotate mode or master mode: Switch to color temperature adjustment by pressing the composite knob, and turn the composite knob to adjust the color temperature.
- APP mode: connect to the APP and adjust the color temperature through the APP.

- Channel adjustment (CH):** Range 1~12.

- Rotate the compound knob in slave mode and APP mode to adjust the channel.
- APP mode: connect to the APP and set the value of the channel through the APP.

- APP control:** Set the mode to APP mode, turn on the phone APP GVM LED, in the Bluetooth search interface, find the Bluetooth with the Bluetooth name BT\_LED and connect, and wait for the connection. After the connection is successful, the camera light can be controlled through the APP.

- Online control: (joint control between lamps and lamps)** Prepare two or more video lights, set one light to master mode, and the others to slave mode, and then set the channel values of all video lights to be the same. After that, you can control the brightness of the slave lights adjusting the brightness of the master light, synchronize the master light and the slave lights.

- You also can use the APP to connect to the master light and control the slave light through the APP.

## APP CONTROL

Scan the QR code on the back of the manual to download the APP.

Turn on the video light and set the mode to APP mode. Open the "GVM\_LED" application software on the phone (The phone needs to turn on Bluetooth and GPS), then enter the Bluetooth search interface → Find the Bluetooth named "BT\_LED" and connect → Wait for the connection → After connecting success, it will automatically enter the app's control interface. At this time, the connected video light can be controlled through the APP.

Color temperature control interface

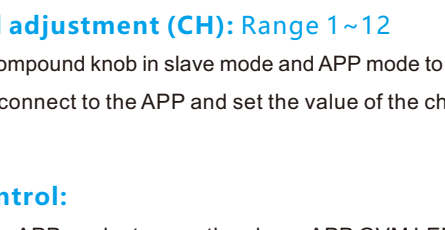

Color temperature control interface

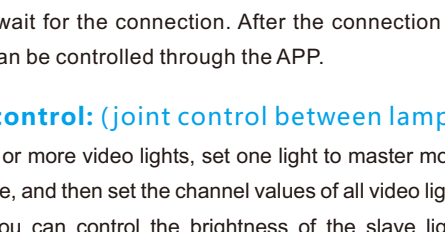

Color temperature control interface

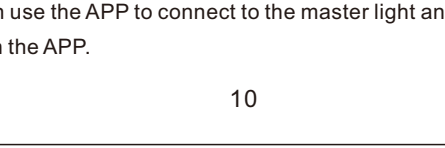

## SIMPLE FAULTS AND TROUBLESHOOTING

Phenomenon	Check the product	Solution
The switch indicator does not light up	Whether the connection between the lamp and the power supply is normal.	Make sure the adapter is well contacted with the power plug.
The product is in the "ON" state, the display and lights are not on	Check if the product is "turned off" by the APP.	① Restart the product. ② Press the APP switch button
APP can't connect / can't control	Check whether the device is in APP mode and whether "BT_LED" is displayed on the APP.	Normal steps: ① Switch to APP mode after booting; ② Turn on Bluetooth and GPS on the phone ③ Open the APP, search and connect to Bluetooth BT_LED

## PRECAUTIONS

- The video light is not waterproof, please use it in a rain-proof environment.
- The video light is not anti-corrosion, please don't let the light come into contact with any corrosive liquid.
- When you use the light, make sure that the light is placed firmly to prevent the light from falling and being damaged.
- When the light is not used for a long time, please turn off the power of it to save energy consumption.

## PACKING LIST

Name	Quantity	Notes
Photography light	1	
Power cord	1	
Adapter	1	
Condenser	1	
Diffuser	1	
Instruction	1	