

封底和封面留白，书本形式

封底

封面

120.00 mm

GVM
GREAT VIDEO MAKER



GVM Official website

Facebook

Web: www.gvmed.com
B&H Email: bnh@gvmed.com
GVM Email: support@gvmed.com
Amazon Email: amazon-support@gvmed.com
Warehouse Add: 4301 N Delaware ave, unit D, PHILADELPHIA, PA19137, USA

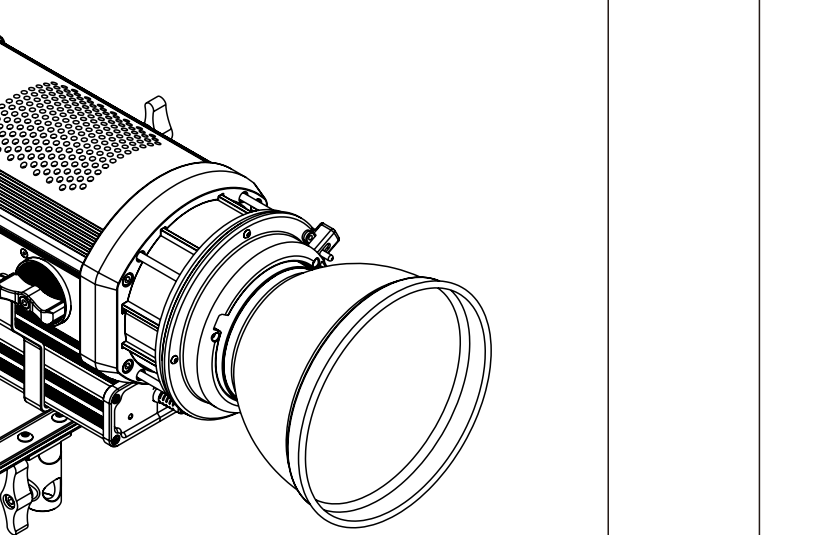

GVM
GREAT VIDEO MAKER

GVM-150D / GVM-150S

CONTENTS

Product introduction	Page 1
Disclaimers	Page 1
GVM-150D Product parameter	Page 2
GVM-150S Product parameter	Page 3
Product structure icon	Page 4
Installation method	Page 5~8
Description of product control keys	Page 9
Description of remote control	Page 10
Function introduction and instruction for use	Page 11~12
Simple faults and troubleshooting	Page 13
Precautions	Page 14
Use and preservation	Page 14
Packing list	Page 15

PRODUCT INTRODUCTION

Welcome to "GVM-150D / GVM-150S". This product is specially designed for senior photography enthusiasts. The product is suitable for live / outdoor / studio photography, and also for youtube video shooting. The main features of the product are:

- ① It has the character of stepless adjusting and it possesses 1 COB lamp bead, which contribute to the recovering and enriching of object colors; it provides you with natural and vivid shooting effect.
 - ② The product has DMX interface, it can be controlled by DMX console.
 - ③ The product has LCD display and stable system, supports 360 rotation, and can effectively control light. Equipped with a standard cover, it can avoid extra light, make the light more concentrated, and customize the control of supplementary light, so that you can easily shoot the desired results at will.
- We firmly believe that the correct use of this product will definitely help your shooting work. Before using the product, we strongly recommend that you carefully read the following user guide.

DISCLAIMERS

1. Before using this product, please read the instructions carefully and make sure use the product correctly. If you don't obey the instructions and warnings, you maybe cause harm to yourself and the people around, or even damage the product and other things around.
2. Once you use this product, you are deemed to have read the disclaimer and warning carefully, understand and acknowledge all the terms and contents of this statement, and promise to take full responsibility for the use of this product and possible consequences.

GVM-150D PRODUCT PARAMETER

- ◆ Product model : GVM-150D
- ◆ Brand : GVM
- ◆ Product Name : Photography lights
- ◆ Product Type : Photography Fill Light
- ◆ Features / Features : Joint control, high display, stepless light control, Console interface
- ◆ Lamp beads quantity : COB*1
- ◆ Color rendering index : ≥97
- ◆ Color temperature : 5600K
- ◆ Brightness: Bare light : 40000lux/0.5m, 7000lux/1m
- ◆ Plus standard cover : 65000lux/0.5m, 9800lux/1m
- ◆ Light adjustment method : stepless adjustment
- ◆ Product Weight : 4.15KG
- ◆ Power : 150W
- ◆ Product Size(mm) : 228*320*315
- ◆ Cooling : Heat sink radiating
- ◆ Product material : Aluminum alloy
- ◆ Voltage : AC:110-240V
- ◆ Power supply mode : AC input
- ◆ Power supply : 32V/6A(Fixed on the lamp body)
- ◆ Commodity origin : China, Huizhou

GVM-150S PRODUCT PARAMETER

- ◆ Product model : GVM-150S
- ◆ Brand : GVM
- ◆ Product Name : Photography lights
- ◆ Product Type : Photography Fill Light
- ◆ Features / Features : Joint control, high display, stepless light control, Console interface
- ◆ Lamp beads quantity : COB*1
- ◆ Color rendering index : ≥97
- ◆ Color temperature : 3200K~5600K
- ◆ Brightness: Bare light : 20000lux/0.5m, 7000lux/1m
- ◆ Plus standard cover : 33000lux/0.5m, 9800lux/1m
- ◆ Light adjustment method : stepless adjustment
- ◆ Product Weight : 4.15KG
- ◆ Power : 150W
- ◆ Product Size(mm) : 228*320*315
- ◆ Cooling : Heat sink radiating
- ◆ Product material : Aluminum alloy
- ◆ Voltage : AC:110-240V
- ◆ Power supply mode : AC input
- ◆ Power supply : 32V/6A(Fixed on the lamp body)
- ◆ Commodity origin : China, Huizhou

PRODUCT STRUCTURE ICON

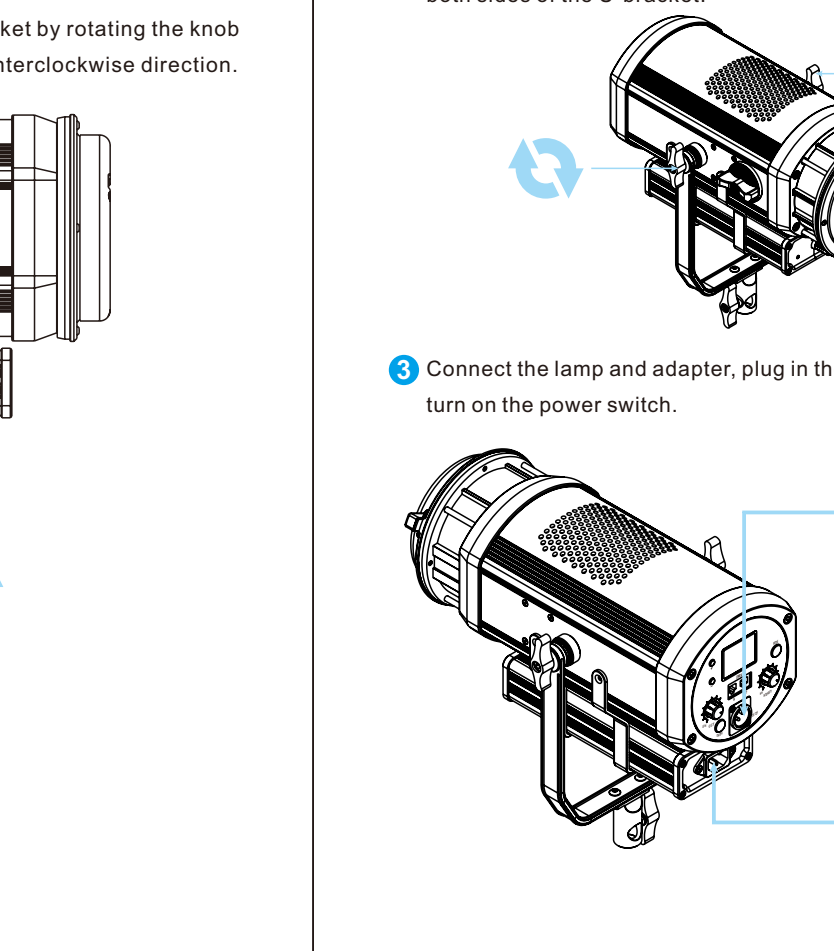

INSTALLATION METHOD

- ① The lamp can be installed and fixed on the bracket by rotating the knob clockwise, and unloaded by rotating in the counterclockwise direction.
- ② Loosen the adjustment knobs on both sides of the U-bracket, adjust the angle of the panel you need, and then tighten the adjustment knobs on both sides of the U-bracket.
- ③ Connect the lamp and adapter, plug in the adapter power cord, and then turn on the power switch.
- ④ Turn the light focus control knob to control the light focus.
- ⑤ Insert the Bowens Mount of the lampshade into the Bowens Mount of the lamp, and then turn it gently clockwise.
- ⑥ Push the Bowens Mount to the upper right, and rotate the lampshade counterclockwise at the same time to disassemble the lampshade.

DESCRIPTION OF PRODUCT CONTROL KEYS

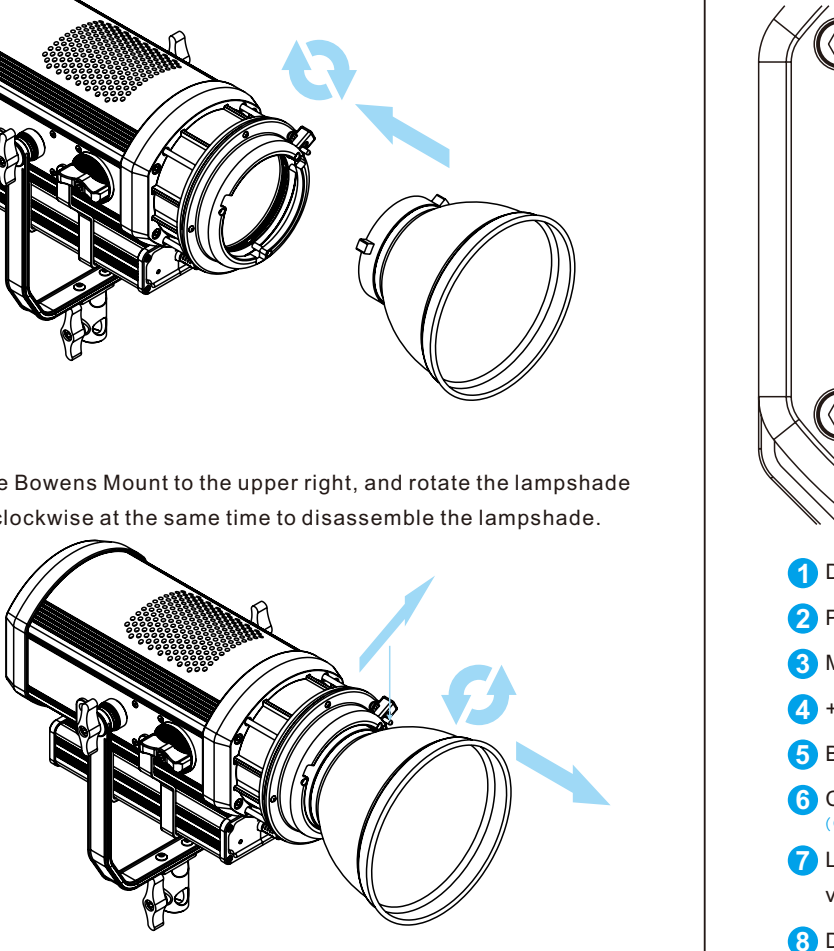

DESCRIPTION OF REMOTE CONTROL

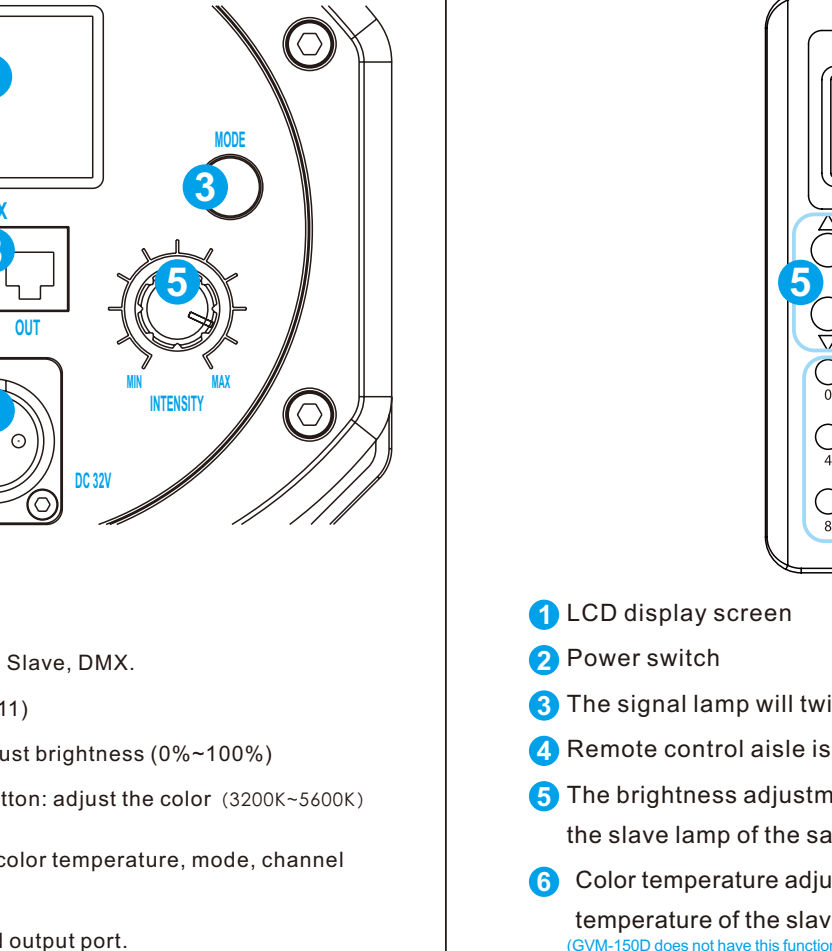

FUNCTION INSTRUCTION & INSTRUCTION FOR USE

- ① **Mode selection :**
Slight press the mode button to shift mode, the mode includes:
Rotate, Master, Slave, DMX.
MODE:Rotate : Adjust brightness and color temperature by rotating rotary knob.
MODE:Master : Adjust brightness and color temperature by rotating the rotary knob and make the slavery machine of the same aisle also adjust synchronously.
MODE:Slave : It can only adjust aisle; master mode and slaver mode can only be synchronously controlled by master mode under the condition that they are under the same aisle.
MODE:DMX : Connect DMX control panel and adjust brightness and color temperature via DMX control panel.
- ② **Adjust brightness (BRG) :** range 10%~100%
• Under master mode/single machine mode, rotating brightness adjusting rotary knob can adjust brightness.
• Under slaver mode, can adjust brightness of lights that are same with remote control aisle by using remote control.
- ③ **Adjust color temperature (CCT) :** range 3200K~5600K
• Under master mode/single machine mode, rotating brightness adjusting rotary knob can adjust color temperature.
• Under slaver mode, using remote control can adjust color temperature of lights that are same with remote control aisle.

PRECAUTIONS

- ① The product is not waterproof, please use it in rainproof environment.
- ② The product is not anti-corrosion, therefore do not let the product touch any corrosive liquid.
- ③ When using the product, make sure the product is put firmly and prevent from falling and damage.
- ④ If the product will not be used for a long time, please switch off the power to reduce energy loss.

SIMPIE FAULTS AND TROUBLESHOOTING

Phenomenon	Check the product	Troubleshooting
The switch indicator does not light up	Check the matching power adapter indicator light up or not.	Make sure the adapter is well contacted with the power plug.
The brightness/color temperature knob is out of control	Check if the mode were set as slave mode, lightness and color temperature of the products cannot be controlled in slave mode.	Press the "MODE" button for once, switch the mode from slave mode to master mode.

USE AND PRESERVATION

Do not put the product in a highly humid, strong electromagnetic field, direct sunlight, high-temperature environment. If not use the product for a long time, disconnect the power.

Clean : Before clean, disconnect the power plug. And use wet cloth rather than any detergent or soluble liquid, avoiding damaging the surface layer.

Power : Make sure the power is in the demanded range, not too high or too low.

Repairing : If there is fault or performance degradation, do not unpack the shell by yourself, avoiding damage the machine and lose the right of maintenance. When there is a fault, do not hesitate to contact us, and we will do our best to deal with the problem.

Accessories : Please use the accessories provided by manufacturer and approved ones, in order to maximize the performance.

Guarantee : Do does not modify the product, or you will lose the right of maintenance.

PACKING LIST

Name	Quantity	Notes
Photography lights	1	
Power Cord	1	
Lamp Shade	1	
Carrying Case	1	
User Manual	1	
The remote control	1	