

GVM[®]
Great Video Maker

GVM-RGB20W

CONTENTS

| | |
|--|------------|
| Important Safety Instructions | Page 1~2 |
| Warning | Page 2 |
| Product Introduction | Page 3 |
| Disclaimers | Page 3 |
| Product Parameter | Page 4 |
| Precautions | Page 4 |
| Product Structure Diagram | Page 5 |
| Installation Method | Page 6~8 |
| Description Of Product Control Keys | Page 9 |
| Function Introduction & Instructions For Use | Page 10 |
| APP Control | Page 11 |
| Quick Troubleshooting | Page 12 |
| Use And Preservation | Page 13 |
| Packing List | Page 13 |
| Product Warranty | Page 14~15 |

IMPORTANT SAFETY INSTRUCTIONS

First and foremost: this product is professional lighting and staging equipment and should be used by a professional lighting technician or under the guidance of a professional. When using this product, you must always follow the cautions below:





1. Read the product manual carefully before use.
2. This product is only suitable to use in a temperature range of -10°C to 40°C.
3. Do not place the equipment near flammable and volatile solvents such as alcohol and gasoline.
4. Before storing the device, make sure it has cooled down completely. When being stored, unplug the power cord from the device. The equipment should be stored in its carrying case or a well-ventilated and dry place.
5. This lighting fixture is not for general illumination and should not be used as such. Individuals with eye injuries or sensitivity should avoid using this lighting fixture.
6. This is a professional light and children are prohibited from using it. Parents or guardians must closely supervise children when they are near the equipment to prevent personal injury caused by colliding with or misusing the equipment.
7. Before using the equipment, please remove the protective cover.
8. When the lighting fixture is on, it is forbidden to stare directly at the light source under any circumstances. High-intensity lighting should only be used under the guidance of a professional lighting technician. Avoid staying in a high-intensity light environment for a long time. If feeling any discomfort, please immediately turn off the lighting fixture, and seek medical attention.
9. When the lighting fixture is on, use it carefully and avoid contacting high-temperature components such as LED light sources to prevent being burnt.
10. Do not use damaged equipment or accessories. Wait for a professional repairman to inspect and repair it before it is confirmed that the equipment can function normally.
11. If the light source is damaged or deformed due to heat, please stop using it and contact the manufacturer, service agents, or qualified repairman promptly to replace the light source to avoid accidents.
12. If the product is cracked due to falling, squeezing, or strong impact during use, please stop use it to avoid being electrically shocked by touching internal electronic components.
13. Do not disassemble the product by yourself. If the product malfunctions, it must be checked and repaired by the manufacturer or authorized repair personnel.
14. Before cleaning and maintenance, be sure to unplug the power supply. To unplug never pull on the cable but always pull the plug itself. This device shall only operate with earthed power outlets or emergency power generators.
15. When cleaning the device, do not wipe it with a wet cloth. Use a dry and soft cloth to wipe off the dirt.
16. If an extension cord is required, it needs to have the necessary capacity to power the respective unit. Using an extension cord with a lower current capacity than the devices need may cause overheating.

17. For some products with long power cords, please place the power cords properly and avoid contact with overheated surfaces that may damage or trip personnel. Please use the original power cords of our manufactory. The damage caused by using non-original power cords is not covered by our repair service.
18. Do not use product accessories that are not recommended by our brand to avoid fire, electric shock, or personal injury.
19. Some products use batteries for power supply. Do not use any batteries, power sources, or accessories that are not specified in the user manual. Please keep batteries and other accessories out of reach of children and infants. If a child or infant swallows a battery or accessory, seek medical attention immediately. If the battery leaks, changes color, deforms, smokes, or emits an odor, remove it immediately. Be careful not to get burned during the removal. Continued use of such batteries may cause a fire, electric shock, or skin burns. Do not use any deformed or modified batteries. Do not disassemble or modify this product or the battery. Do not heat the battery or solder it. Do not let the battery come into contact with fire or water, or subject it to strong external force. Do not insert the battery's positive and negative ends incorrectly, or mix and use old and new batteries or different types of batteries.
20. For some products with built-in lithium batteries, please use a dedicated charger for charging, and following the correct operating instructions within the prescribed voltage and temperature range.
21. The warranty last for one year. Consumables like batteries, adapters, power cords, and other accessories are not covered by the warranty.
22. The one-year warranty will be invalidated if the equipment is found to have been repaired privately. The related repair costs will be charged.
23. Equipment malfunctions caused by non-standard operations are not covered by the warranty.
24. The safety instructions are based on our factory's strict testing. If there are any changes in the equipment's design and specifications, we reserve the right not to notify you. Customers can visit our official website to check the latest digital version of the instructions and learn about the newest product information.

Keep these instructions!



WARNING:

-  High-power LED lights are strictly prohibited from being directly viewed or shining into other people's eyes.
-  Do not unplug the power cord or connecting wires while the light is on to avoid personal injury.
-  Do not cover the heat dissipation port when the lamp is in operation.
-  Keep children away from touching or using this light.
-  As professional lighting equipment, please make sure to operate it correctly according to the user manual.

PRODUCT INTRODUCTION

Thank you for purchasing our "GVM-RGB20W". This product is specifically designed for photography and videography enthusiast. This product is suitable for use in live stream /outdoor /studio and YouTube shoots.

The main features of the product are:

1. Step-less adjustable RGB color and dual color temperature feature, color range 2700K~10000k, with 162 LED bulbs, which is helpful to restore and enrich the color of objects and provide you with natural and vivid shooting effect.
2. APP intelligent control system, which can be controlled by your intelligent mobile device.
3. With OLED screen display and stable system. Supports 180° rotation, which can effectively control the light, allows you to easily shoot the desired results at will.
4. The product can simulate 8 kinds of scene lights: Lightning, Police car, Candlelight, TV, Bad light bulb, Party, disco, Paparazzi.

We firmly believe that the correct use of this product will be of great help to your production workflow. It is strongly recommended that you read the following user guide carefully before using this product.

DISCLAIMERS

1. Before using this product, please read the text carefully to ensure that the correct operation of the product has been carried out. Failure to follow and not following the instructions and warnings in this document may cause harm to you and others around you, or even damage the product or other surrounding items.
2. By using this product, you are deemed to have carefully read the disclaimer and warning, understand and acknowledge all the terms and contents of this statement, and promise to take full responsibility for the use of this product and the possible consequences.
3. Design and specifications are subject to change without notice.

PRODUCT PARAMETER

- ◆ Brand : GVM
- ◆ Product Model : GVM-RGB20W
- ◆ Product Name : Photography Lights
- ◆ Product Type : Photography Fill Light
- ◆ Features : High Color Rendering Index Light Beads, APP Control, Portable, Scene Light, RGB Light
- ◆ Bluetooth Controllable Distance: ≤15M
- ◆ Light Adjustment Method : Step-less Adjustment
- ◆ Color Rendering Index : ≥97
- ◆ Color Temperature : 2700K~10000K
- ◆ HUE : Rgb 0°~360°
- ◆ SAT : 0%~100%
- ◆ Illuminance : 310lux@1m ; 1147lux@0.5m
- ◆ Power : 20W
- ◆ Product Weight : 0.4KG
- ◆ Product Size (mm): 242×106×30
- ◆ Light Beads Quantity : 162 Light Beads
- ◆ Power Supply Mode : DC Input & Battery
- ◆ Voltage : DC 9V
- ◆ Power Supply : DC 9V/3A
- ◆ Battery Capacity : NP Series Battery
- ◆ Cooling : Natural Heat Dissipation
- ◆ Product Material : Plastic
- ◆ Commodity Origin : Huizhou. China

PRECAUTIONS

1. Please use the matching power adapter or lithium battery with the same specification to power the product. Do not use power adapter with different output voltage parameters.
2. The product is not waterproof, please use it in a rainproof environment.
3. The product is not anti-corrosion, therefore do not let the product touch any corrosive liquid.
4. When using the product, make sure the product is put firmly and prevents falling and damage.
5. If the product will not be used for a long time, please switch off the power to reduce energy loss.

PRODUCT STRUCTURE DIAGRAM

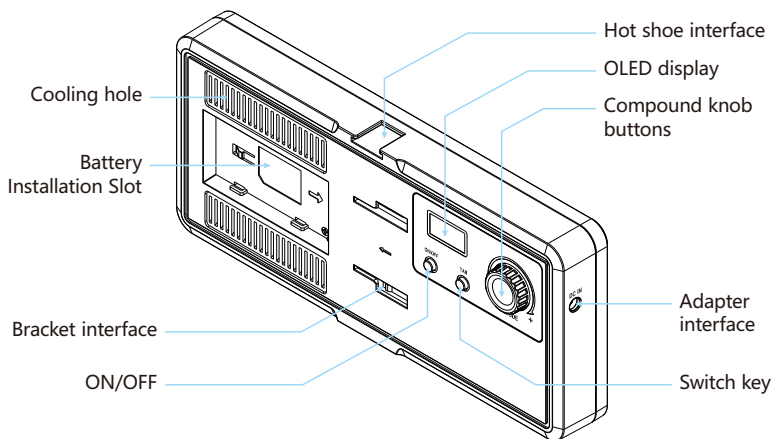

GVM-RGB20W

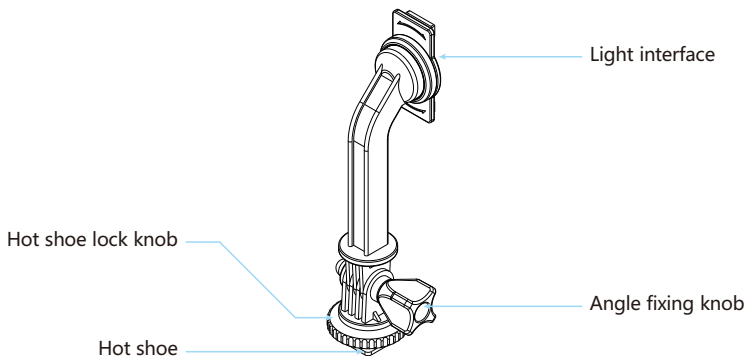

Hot Shoe Bracket

INSTALLATION METHOD

- ❶ The steps of hot shoe bracket installation are shown in the figure below.

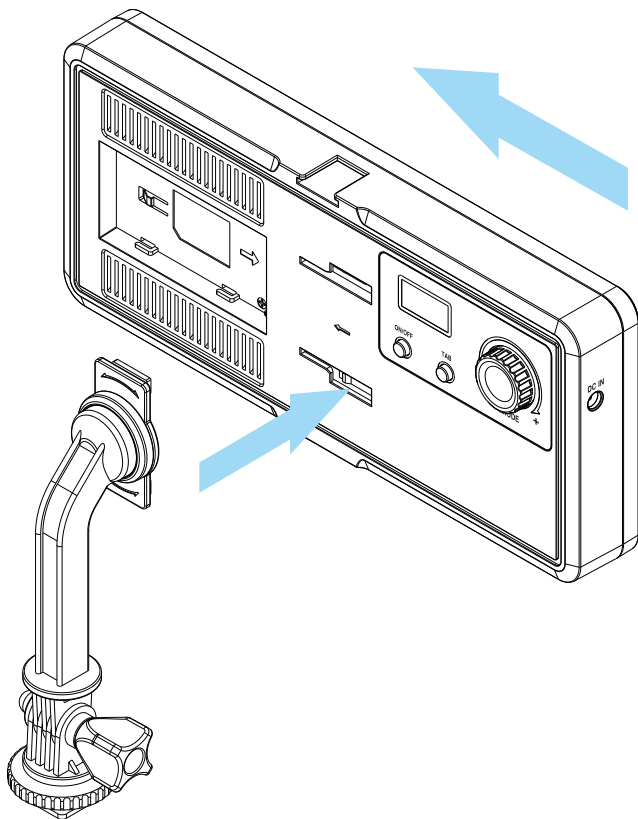

- 2 Install it on the camera as shown below.

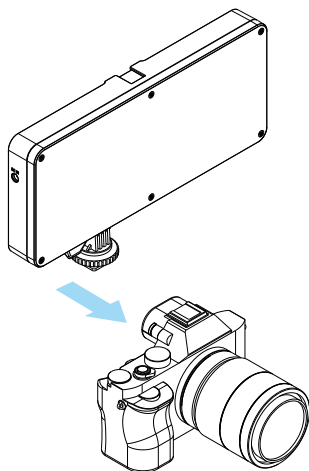

- 3 Loosen the angle locking knob of the hot shoe bracket, adjust it to the proper angle, and tighten the knob.

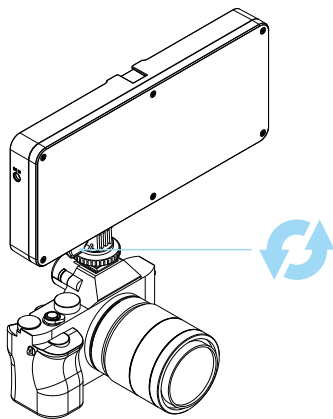

4 There are two power supply modes to choose.

1. Connect the adapter for power supply.
2. Insert a suitable lithium battery and use a battery power supply.

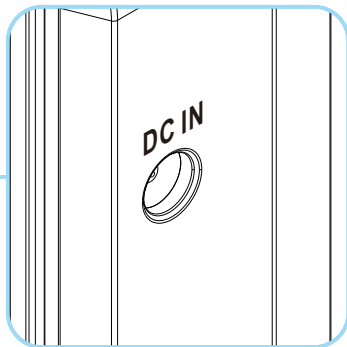
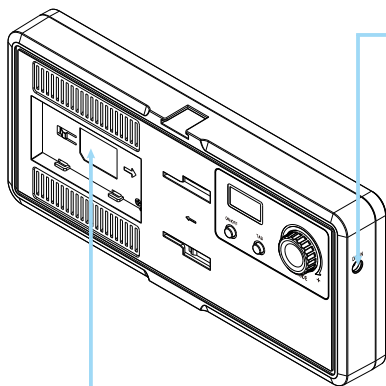

Adapter Interface

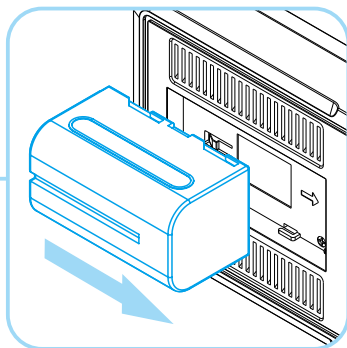

Battery Installation Slot

DESCRIPTION OF PRODUCT CONTROL KEYS

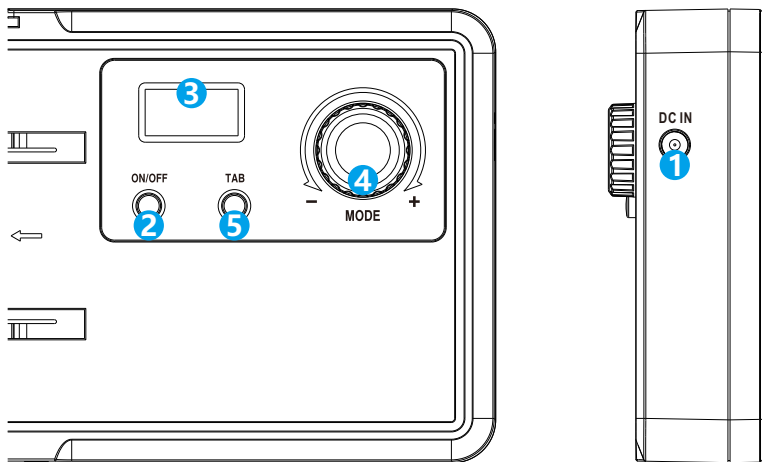

- ① DC power input interface.
- ② Power switch: Long press to turn on.
- ③ Electronic display: display the current information of the photography light.
- ④ Compound knob: Press the knob button to switch modes (CCT, HSI, SCENE), and turn the knob to adjust the lighting parameters.
- ⑤ Switch key: Switch the currently adjustable parameters, including: brightness, color temperature, hue, color purity and other parameters.

FUNCTION INTRODUCTION & INSTRUCTIONS FOR USE

① Mode selection :

Rotate the compound knob to select the mode, and lightly press the compound knob to enter the mode.

Modes include : CCT, HSI, SCENE

CCT: Adjust the brightness and color temperature through the compound knob or APP.

HSI: Adjust the brightness, hue and color purity through the compound knob or APP.

SCENE: There are 8 scenes: Lightning, Cop Car, Candle, TV, Bad Bulb, Party, Disco, Paparazzi, Use the compound knob to select the scene and adjust the brightness, color temperature, time and other parameters.

② Adjust brightness (BRG): range 0%~100%

- There is brightness adjustment in any mode. Press the composite knob button to switch to the desired mode → press TAB to switch to brightness adjustment → turn the composite knob to adjust the brightness.
- The brightness can be adjusted by APP when connected to APP.

③ Adjust color temperature (CCT): range 2700K~10000K

- Press the compound knob to switch to CCT mode → press TAB to switch to color temperature adjustment → turn the compound knob to adjust the color temperature.
- The color temperature can be adjusted by APP when connected to APP.

④ Adjust HUE: range 0° ~ 360°

- Press the composite knob to switch to HUE mode → press TAB to switch to hue adjustment → turn the composite knob to adjust the hue.
- The HUE can be adjusted by APP when connected to APP.

⑤ Adjust color purity(SAT): range 0%~100%

- Press the composite knob to switch to SAT mode → press TAB to switch to color purity adjustment → turn the composite knob to adjust the color purity.
- The SAT can be adjusted by APP when connected to APP.

⑥ Adjust the scene mode(SCENCE):

- Press the composite knob button to switch to SCENE mode → press the TAB key to select DOM → turn the composite knob to switch scenes → press the TAB key to select the parameter to be adjusted → rotate the composite knob to adjust this parameter.
- Connect the APP, set scene light mode through the APP.

APP CONTROL

1. Scan the QR code on the back of the manual to download the APP.
2. Turn on the light, switch mode to APP mode, confirm that the phone Bluetooth and APP Bluetooth permission is open (Android needs to open GPS and APP positioning permission). Then open the "GVM LED" application, enter the Bluetooth search interface (Figure 1), find the Bluetooth named "BT_LED" and click connection button, after successful connection, automatically enter the APP control interface (Figure 2/3/4), at this time, you can control the connected camera light through APP can control the connected light. If there is a slave, the APP will synchronously control the slave of the same channel as the connected APP mode machine.

Note: Please do not pair Bluetooth in the system Bluetooth page, directly open the APP and the light Bluetooth system pairing connection.

3. You can save 6 custom light effects in "My Scenes".
After setting the light effect parameters → click the "⌘" icon in the right corner → pop up the "Save Current Scenes" → click "OK". This light effect can be found in "My Scenes" at this time. (Figure 5)

Figure 1

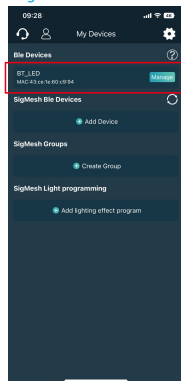

Figure 2



Figure 3

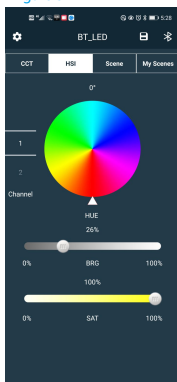

Figure 4

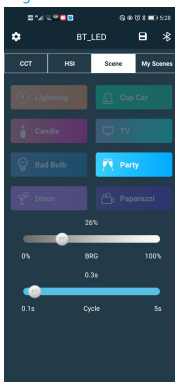
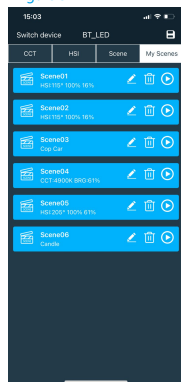

Figure 5



QUICK TROUBLESHOOTING

| Phenomenon | Check the product | Troubleshooting |
|--|--|---|
| The switch indicator does not light up. | ① Check the matching power adapter indicator light up or not. | Make sure the adapter is well contacted with the power plug. |
| | ② When using lithium battery, make sure there's no "low power" protection. | Charge the battery before using it. |
| The brightness / color temperature knob is out of control. | Check if the mode were set as slave mode, lightness and color temperature of the products cannot be controlled in slave mode. | Press the "MODE" button for once, and switch the mode from slave mode to master mode. |
| The product is in the "ON" state, the display and lights are not on. | Check if the product is "OFF" because of the APP on the mobile phone. | Press the "ON/OFF" button once again. |
| APP can't connect / can't control. | Check whether the device is in APP mode and whether "BT_LED" is displayed on the APP. | Normal steps: ① Switch to APP mode after booting; ② Turn on Bluetooth and GPS on the phone; ③ Open the APP, search, and connect to Bluetooth BT_LED. |
| In RGB mode, the lamp beads have no RGB color. | Check whether the saturation (SAT) value is too low or 0. The most obvious difference is color when the saturation value is 100. | ① In the main control mode / self-control mode, adjust the saturation value with the multifunctional knob. ② Connect to the APP in APP mode and adjust the saturation value through the APP. |

USE AND PRESERVATION

Do not place the product in a high humidity, strong electromagnetic field, direct sunlight, or high-temperature environment. If the product will not be used for a long time, please disconnect its power and remove the battery.

Clean: Before cleaning, disconnect the power plug. And use a damp cloth instead of any detergent or soluble liquids to avoid damaging the surface layer.

Power: Make sure the power is within the demanded range, not too high or too low. Correctly load the battery, in order not damage to the machine.

Repairing: If there is a fault or performance degradation, do not unpack the shell by yourself, avoiding damage to the machine and losing the right of maintenance. When there is a fault, do not hesitate to contact us, and we will do our best to deal with the problem.

Accessories: Please use the accessories provided by the manufacturer and approved ones, to maximize the performance.

Warranty: Do not modify the product, or you will lose the right to maintenance.

PACKING LIST

| Name | Quantity | | | | Notes |
|---------------------|----------------|-------------------|---------------------|--------------------|-------|
| | GVM- RGB20W | GVM- RGB20W-1L | GVM- RGB20W-2KIT | GVM- RGB20W-KIT | |
| Photography lights | 1 | 1 | 2 | 1 | |
| Hot Shoe Bracket | 1 | 1 | 2 | 1 | |
| Desktop Light Stand | | 1 | | | |
| Adapter | | 1 | 2 | 1 | |
| Lithium battery | 1 | | | | |
| Battery charger | 1 | | | | |
| Light stand | | | 2 | | |
| User Manual | 1 | 1 | 2 | 1 | |

PRODUCT WARRANTY

Dear user, this warranty card is important proof for applying for warranty service. Please cooperate with the salesperson to fill it out and keep it properly. Thank you!

| | | |
|---------------------|-----------------|-----------------|
| Product Information | Model Number | Product Barcode |
| User Information | Name | Contact Number |
| | Mailing Address | |
| Seller Information | Name | |
| | Contact Number | |
| | Mailing Address | |
| | Sales Date | |
| Remarks | | |

Note: this form should be confirmed by the salesperson's stamp.

Applicable Products

This document applies to the products listed in the relevant "Product Warranty Information" (see instructions below). Other products or components that do not fall within this scope (such as promotional products, gift items, and other components added after the factory) are not covered by this warranty promise.

Warranty Period

The corresponding warranty period for products and components shall be executed according to the relevant "Product Warranty Information". The warranty period starts from the first day of purchase of the product, and the date of registration on the warranty card at the time of purchase shall prevail.

How to Obtain Warranty Service

You can directly contact the product salesperson or authorized service agency, or call GVM's after-sales service hotline to contact us and have our service personnel arrange service for you. When applying for warranty service, you should provide a valid warranty card as a warranty certificate to be eligible for warranty service. If you cannot provide a valid warranty card, we may also provide you with warranty service under the circumstance that our products or components are confirmed to be within the warranty scope, but this is not our obligation.

Cases where warranty does not apply:

If the product meets the following conditions, the warranty and service under this document will not apply:

1. The product or parts have exceeded the corresponding warranty period.
2. Malfunctions or damages caused by incorrect or improper use, maintenance, or storage, such as improper handling, use for purposes other than the reasonable expectations of the product, incorrect insertion or removal of external devices, falling or crushing due to external force, or exposure to inappropriate temperature, solvents, acids, alkalis, water immersion, or damp environments.
3. Malfunctions or damages caused by unauthorized installation, repair, modification, addition, or disassembly by institutions or personnel not authorized by GVM.
4. Modifications, changes, or removals of the original identification information of the product or its parts.
5. Lack of valid warranty card.
6. Malfunctions or damages caused by the use of unauthorized, non-standard or non-publicly released software.
7. Malfunctions or damages caused by force majeure or accidents.
8. Other malfunctions or damages not caused by quality issues of the product itself. In such cases, you should seek solutions from the relevant responsible parties, and GVM will not be held liable. Malfunctions or damages caused by components, accessories, or software not covered by the warranty or beyond the warranty scope that renders the product unable to function properly are not covered by the warranty. Fading, wear, and consumption that is normal during the product usage process are not covered by the warranty.

Product Warranty and Service Support Information

The product warranty period and service types are implemented according to the following "Product Warranty Information" for each product category, component, and optional equipment:

| Product Category | Accessories Name | Warranty Period(Month) | Warranty Service Type |
|------------------|--|------------------------|-------------------------|
| Component | Circuit Board. | 12 Month | Customer service repair |
| Other | Spotlight mount, softbox, adapter, Standard reflector, power cord, battery Handle, light stand, TYPE-C cable, battery slot, battery, Fresnel lens, grid, carrying bag and all other accessories, etc. Consumable or electrically sensitive parts are not covered by the warranty. | None | No Warranty |

**QC
PASS**



GVM Official website



Facebook



Download APP

Huizhou Latu Film Equipment Co., Ltd.

Web: www.gvmled.com

B&H Email: bh@gvmled.com

GVM Email: support@gvmled.com

Amazon Email: amazonsupport@gvmled.com

Warehouse Address: 12285 MCNULTY RD, STE 105 PHILADELPHIA, Pennsylvania 19154, USA